



SINGER®

STITCH GAUGE & GUIDE

For precise & consistent seam allowances



Two piece tool set to achieve precise and consistent seam allowances between 1/8 inch to 1 inch.



Step 1

Starting with the gauge, slide under the presser foot to position the needle above desired seam with hole.

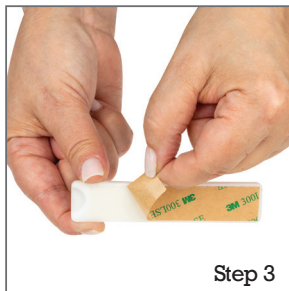

Step 2

Lower the needle into the hole, place the presser foot down to hold gauge in place.

Step 3

Remove protective adhesive backing from the guide and set aside (do not throw away). The tacky feels means it is ready to apply to surface.

Step 4

Align guide butting up along the edge of the gauge and press into place.



Step 5

Raise the presser foot and needle to remove the gauge leaving the guide to begin sewing desired seam allowance by running fabric along the guide.

Tips: Keep the protective cover over adhesive strip when not in use. If protective strip is lost household wax paper can be used instead. To remove lint build up on the adhesive tack strip, spray with a little glass cleaner and gently rub linty area with thumb or finger. The lint will float to surface as you rub. Rinse debris away with warm water and let air dry. Guide will be ready to use again in a few minutes.